

CORVUS PKE

RABE TECHNOLOGY

POWER HARROWS RABE TECHNOLOGY

Corvus PKE | Corvus PKE K



GRÉGOIRE
BESSON



FOR TRACTORS FROM 85 TO 230 HP

Corvus PKE

Power harrows Rabe Technology

CORVUS PKE and PKE K

Due to its external development, and in particular through the take-over of the Rabewerk German company, Grégoire-Besson has completed its range of products with power harrows. These power harrows benefit from the German know-how and experience, allowing Grégoire-Besson to offer a performant, enduring and proven range of machines.



- High-positioned reinforced driving system, appropriate to strong-powered tractors (no mechanical stress on the cardan during work)
- Rear PTO is optionally available

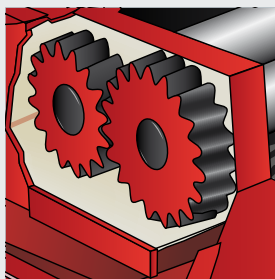

- Robust driving system for HP requirement up to 230 HP
- Interchangeable pinions for rotating variation



- Assembly with double flat ball bearings, mounted on a shaft D. 55 mm --> No deformation problem
- Ball bearings are positioned on the frame structure

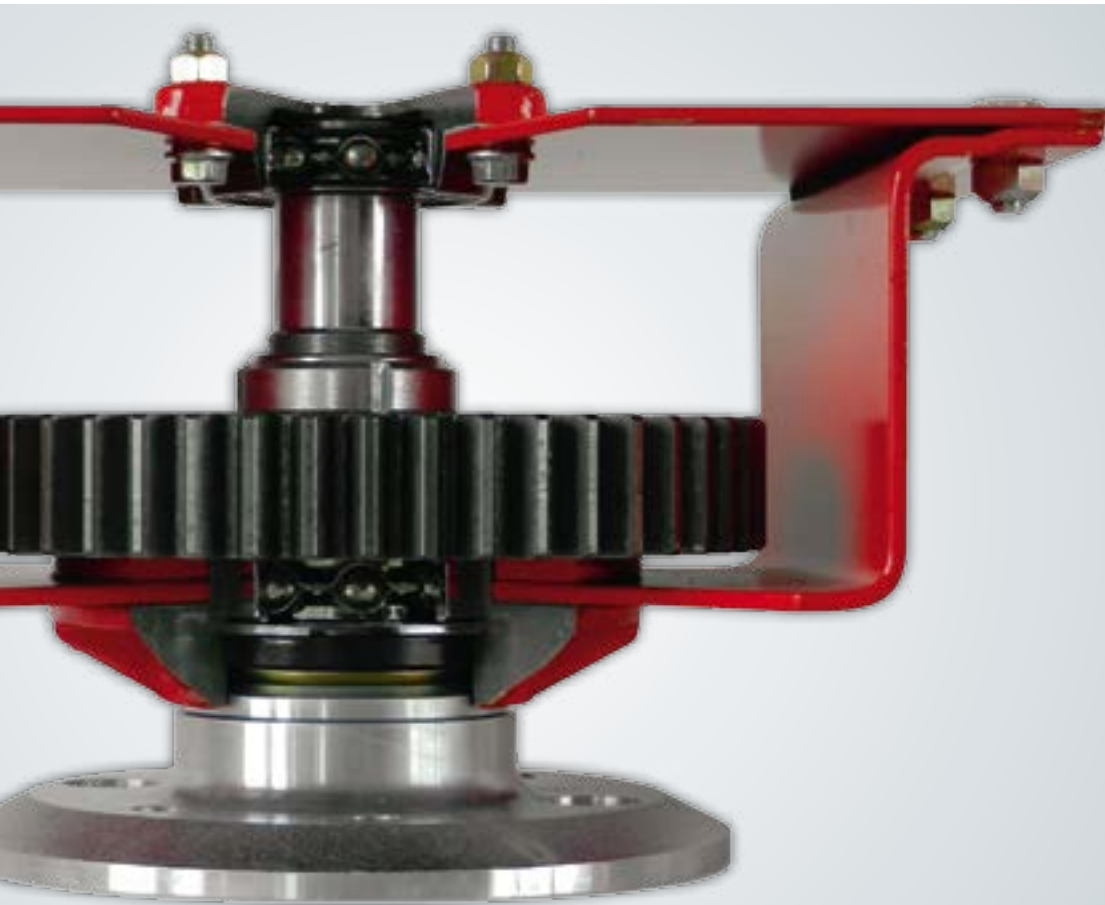

- Reinforced assembly with ball bearings fitted at the rotor extremities (2 bearings of same diameter) --> Driving gear placed between the bearings (spacing of 13,5 cm) --> It offers more rigidity when hitting obstacles, and avoids lateral forces
- Rigid shaft of 55 mm diameter

- Gear housing in cold-worked steel for more resistance and rigidity
- Thickness 6 mm
- Groove for seal placement

4 rotors per meter

- Wearing part optimization
- Good clod breaking, particularly in difficult conditions
- Overlapping of the working elements for a homogeneous soil preparation
- Less HP power requirement for the same result
- Perfect levelling
- Machine overall dimensions = worked width

Corvus PKE

Efficiency, versatility and performance

The power harrows PKE and PKE K (foldable) are available in 2,50 to 6,00 m working width. They are ideal for soil preparation after ploughing and for seeding on pre-loosened soils. The PKE range is enduring thanks to its gear housing in cold-worked steel, 6 mm thick.

THE WHOLE volume of earth passes through the tines, which ensures a homogeneous finish.



- Lower link hitch cat. II & III
- Depth adjustment of the hitch positions



- Track eradicators, with spring-loaded protection
- Side plates with two positions work / transport (real working width = 3,00 m)
- Suspended machine (stone protection springs)

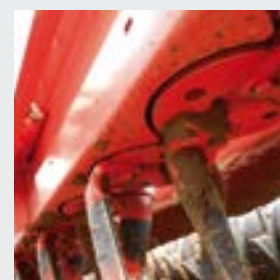
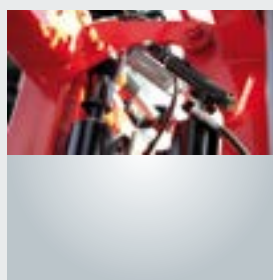

- Wrap around protection bar at front (option)
- No stone jamming under the gear housing
- Efficient protection of bearings
- The volume of earth is obliged to pass through the rotors



- Rear clod bar, adjustable by means of spindle (option)
- Curved shape, to make the earth evacuation easier



- Rear three-point linkage reinforced with single-acting central ram (option)
- Multi-position arms, with height and depth adjustment
- High lift capacity (over 2 Tonnes) on the whole ram stroke

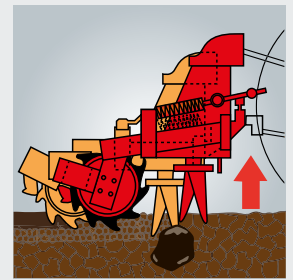

Suspended gear housing

The stone protection spring operates as a safety device against obstacles (option).

- When tripping, the gear housing releases, taking support on the roller

Corvus PKE





A large and full range

CORVUS PKE

This range is appropriate for tractors from 80 to 230 HP, and the assembly of 4 rotors per meter meets requirements concerning output and working quality.

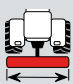

Technical specifications

				KG
CORVUS PKE (FIXED)				
2,50	2,50	4	230	950
3,00	3,00			1050
3,50	3,50			1220
4,00	4,00			1380
CORVUS PKE K (CAN BE FOLDED)				
4,00	2,50	4	250	1900
4,50				2050
5,00				2200
6,00				2540

ROLLERS

Large choice in the rollers to equip the Gregoire-Besson power harrows.

Packer roller, Gregoire-Besson know-how

- Precision steel tube (no roundness imperfection)
- Rows of packer tines, with a spacing of 125 mm --> High seeding precision
- The packer tines are treated and welded on both sides of the roller

	PKE				PKE K			
	2,5	3	3,5	4	4	4,5	5	6
Crumbler roller D. 540	●	●	●	●	●	●	●	●
Packer roller D. 510	●	●	●	●	●	●	●	●
Mulch packer D. 500	-	●	-	-	-	-	-	●
Furrow packer RIPA D. 580	●	●	●	●	●	●	●	●

● : Available / - : Not available

Packer roller



Crumbler roller



Furrow packer RIPA



TINES AND TINE-HOLDERS



Bolted tines (standard). Multi-Fix version adaptable.

- Multi-Fix support can be bolted on the tine-holder
- Multi-Fix tines, with Quick-Change fittings (option)
- Tine fixation by means of axles and pins
- The tine is entirely blocked in its support

RABID HARD COATING

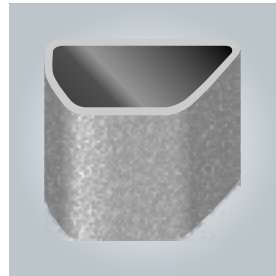

RABID hard coating : Gregoire-Besson exclusivity

- Long-lasting improved (up to 3 times longer) than a normal tine
- Solid binding of hard coating on base material
- Coating thickness = 2 mm
- Regular and homogeneous treatment on all the surface
- No additional tractor power is required.



A l'épreuve du temps

GRÉGOIRE-BESSON

49230 Montfaucon-Montigné - France
Tél. (+33) 2 41 64 72 67
Fax (+33) 2 41 64 67 73
contactfr@gregoirebesson.fr

GREGOIRE-BESSON UK LIMITED

Spalding Road
Bourne
Lincs. PE10 0AU - England
Tel : 01778 423787
Fax. : 01778 394431
enquiries@gregoire-besson.co.uk

GRÉGOIRE-BESSON CANADA INC

4480, Rue Martineau
St Hyacinthe (P. Québec) J2R 1V1 - Canada
Tel (1) 450 799 56 15
info@gregoirebesson.ca

GREGOIRE-BESSON GmbH

Am Rabewerk 1
D - 49152 Bad Essen - Germany
Tel (+49) 5472-771 0 / (+49) 5472-771 190
E-mail : info@rabe-agri.eu

ГРЕГУАР-БЕССОН ВОСТОК

Россия 308006 г. Белгород,
ул. Корочанская, 132а
Тел/факс: +7(4722) 58 70 36
Тел: +7(4722) 58 70 35

ТОВ «ГРЕГУАР-БЕССОН УКРАЇНА»

18028, Україна, Черкаська обл.,
м. Черкаси, вул. Рози Люксембург, буд. 202.
UKRAINE
тел. : +38 (0472) 71-28-23
факс: +38 (0472) 71-28-23
gregoirebesson.ua@yandex.ua

GREGOIRE-BESSON POLSKA Sp.zo.o.

Kowanówko
ul. Obornicka 1a
64-600 Oborniki - Polska
Tel/fax : 067 261 97 79
gbesson@poczta.onet.pl

GREGOIRE-BESSON BEIJING OFFICE

法国格力格尔-贝松公司北京代表处
100025北京市朝阳区延静里中街3号 长信大厦220室
Tel: 010-65 08 06 40; Fax: 010-65 08 06 41.

www.gregoire-besson.com

CORVUS PKE

RABE TECHNOLOGY